



Satus FENCE™







Satus FENCE

Satus Fence



Satus FENCE

Available in three colours:

Anthracite Grey  RAL7016	Merlin Grey  BS 18B25	Goosewing Grey  BS 10A05
--	---	--

Satus Fence is committed to continuously providing customers with better product design and experience.

Satus fences not only offer a fence product that meets your needs, but also enrich your life with diverse combinations and reliable quality. They are continually updated and improved to provide the best product for professionals and individuals to secure their areas.

Satus Fence

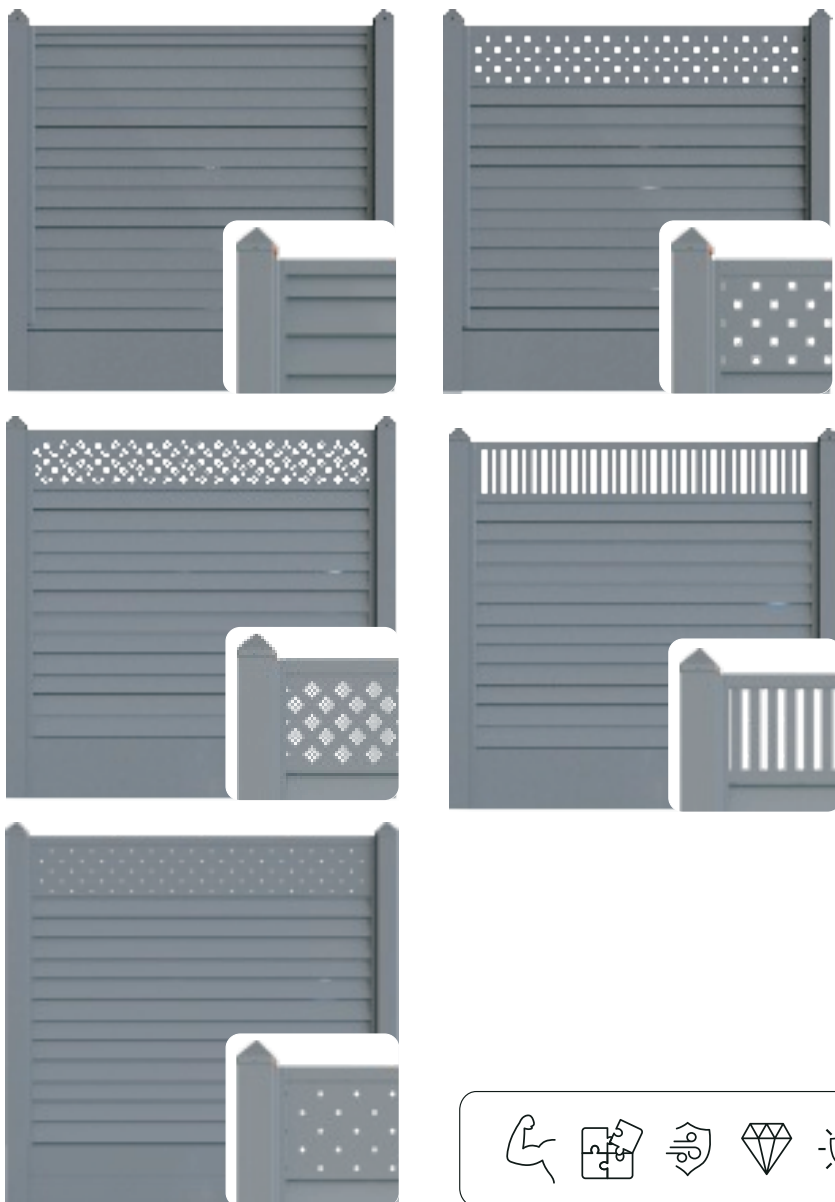



Satus FENCE

Infill Panel



Satus FENCE

Satus fences come with the option of two different infill panel styles. The traditional panel has a shiplap design. The 'contemporary panel' eludes a modern fashionable vibe. Both designs feature a unique bullet nose locking mechanism for easy installation and increased panel stability.

Material: Steel

Surface treatment: Textured powder coated

Dimensions: L1780xW315mm

Infill Panel

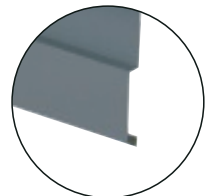
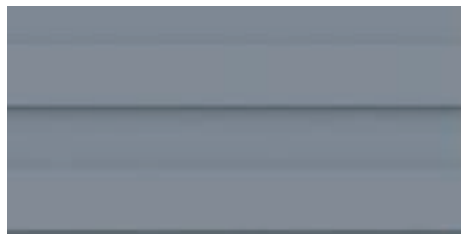
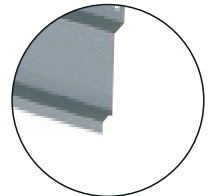
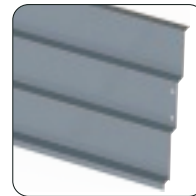
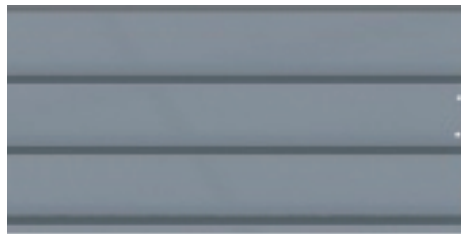

Unique Bullet Nose Locking



Satus FENCE

**Rich Decorative
Trellis Design**



Satus FENCE

The intelligent fence features a modular design that can be 100% opaque or combined with various decorative panels of different styles to assemble your fence. The slightly open fence allows light to shine through, adding some vitality.

Materials: Steel

Surface treatment: Textured powder coating

Dimensions: L1780×W300mm

Rich Decorative Trellis Design



Round Holes Trellis



Squares Holes Trellis

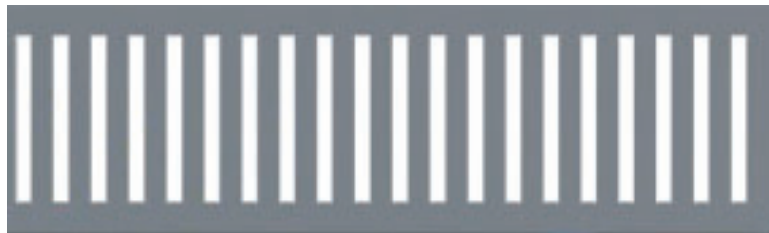

Vertical Line Trellis



Diamond Holes Trellis

Garden Gate

The satus fence offers optional garden gates that match the style of the fence. It is composed of an aluminum door frame filled with embedded panels.

Gates can be customised to make them smaller and trellis can be added if required. Gate hinging system allows gate fitting to walls or to special designed gate post.

If you require double gates you can purchase two single gate remove lock from one gate and add gate stopper accessory which slots into lock slot. A gate lock stopper can be purchased as an accessory for double gates.

Double Gate



Single Gate

Available Size:
1m and 1.2m

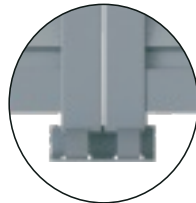
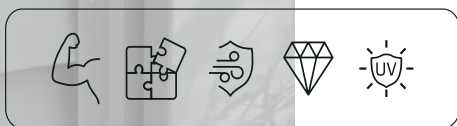

Gate Lock Stopper

Gate Posts

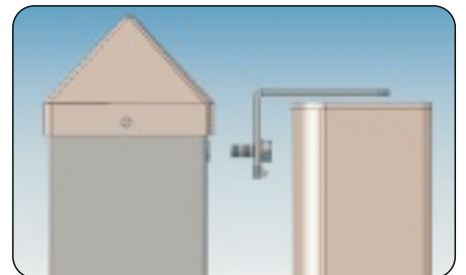
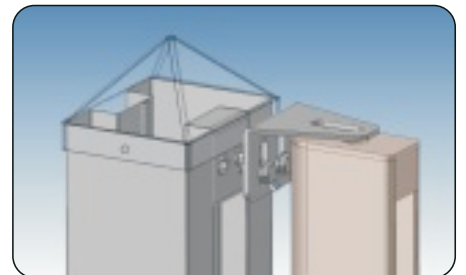

Installation of Gate

Satus FENCE

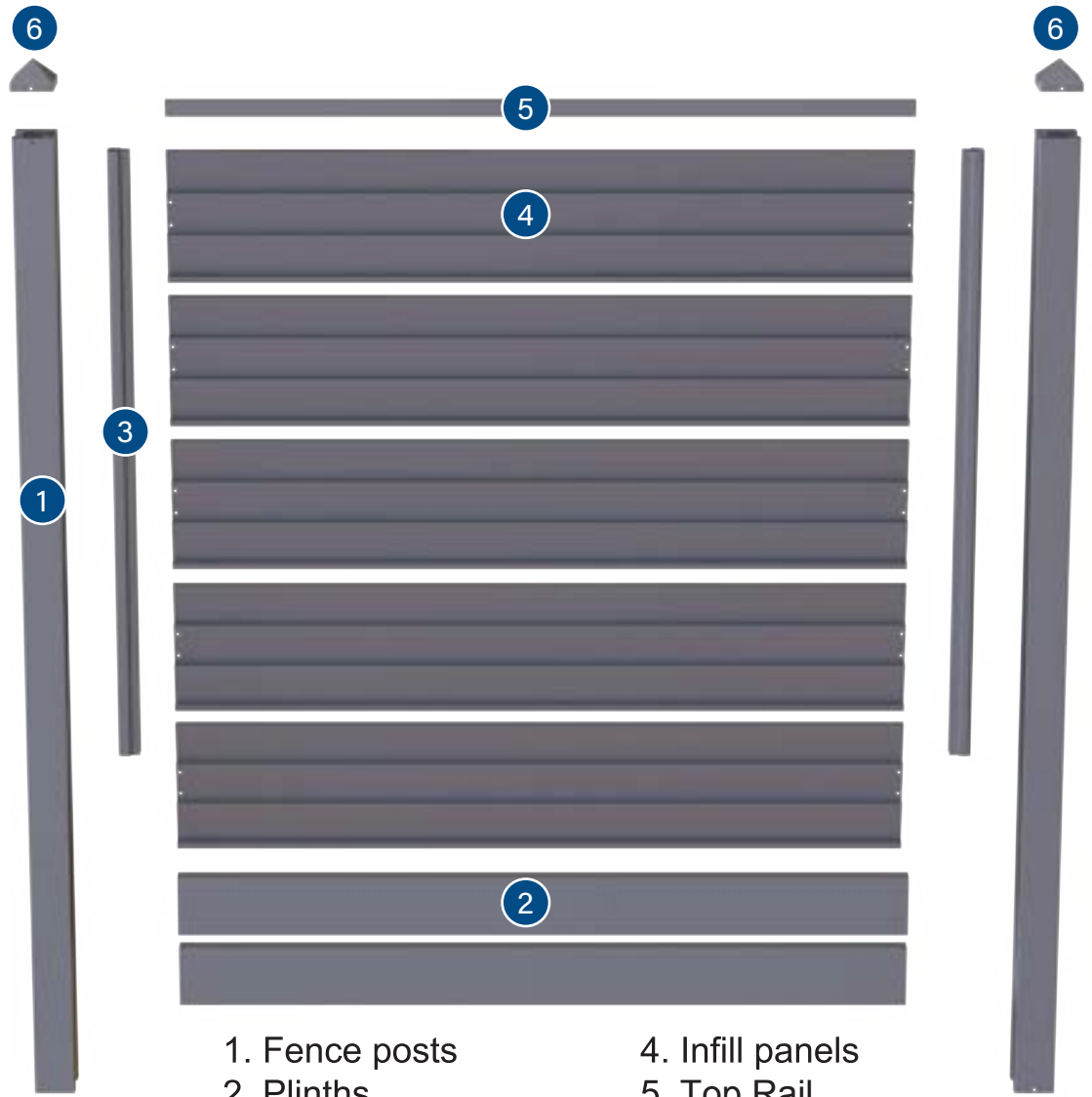

- 1. Fence posts
- 2. Plinths
- 3. Channel adapter

- 4. Infill panels
- 5. Top Rail
- 6. Post Caps

Satus FENCE

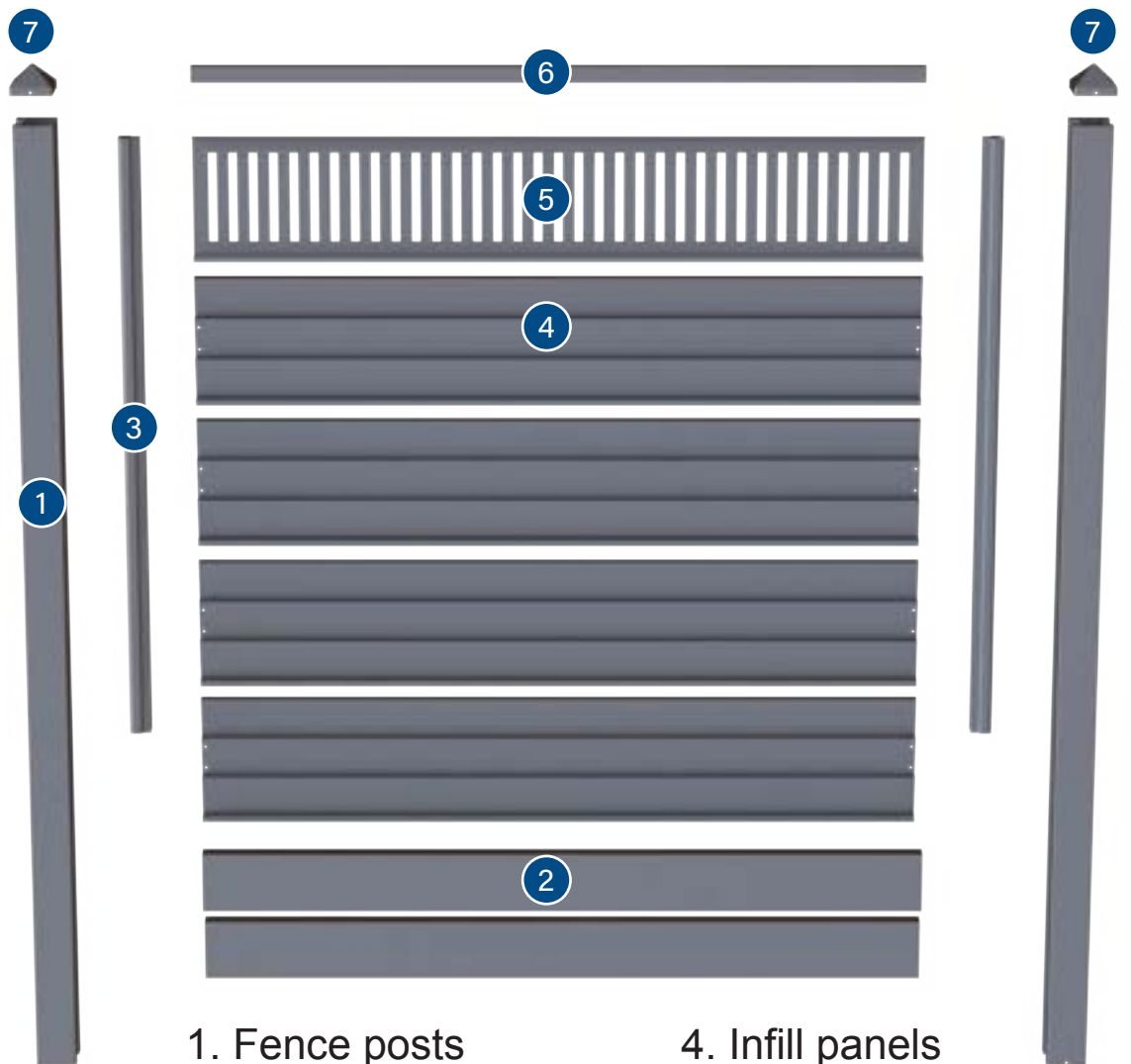

1. Fence posts
2. Plinths
3. Channel adapter

4. Infill panels
5. Trellis
6. Top rail
7. Post caps

It is compulsory to treat any cut area as shown here with galvanise spray paint to keep warranty

1.

Cut with a nibbler, mini disk (use extra slim disk) or hand shears.



2.

Clean all of the cut metal area thoroughly with file and mini disk.



3.

Using masking tape on cut out area leaving 10mm exposed.

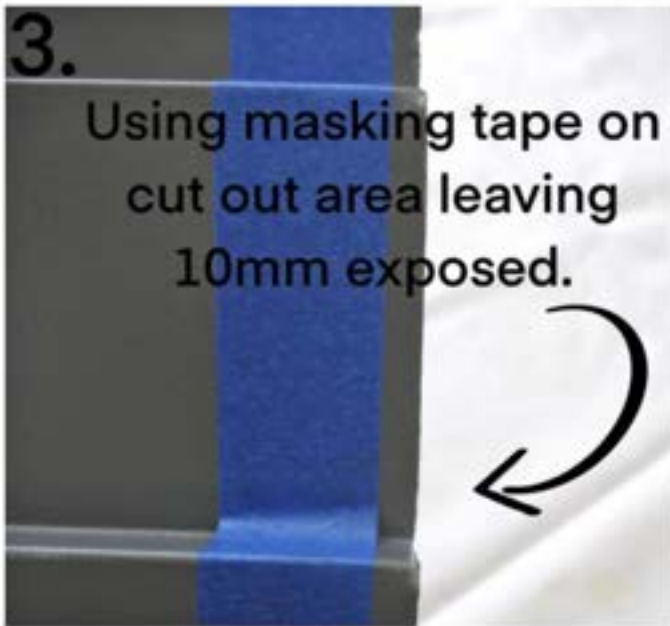

4.

1. Spray 10mm cut area at least 3 times with galvanise spray.

2. When dry remove masking tape.

* All areas that have been cut will be hidden after fitting.



Fitting Instructions.

1. If you have concrete posts and plinths in your garden start at photo no. 3. Pre drill the concrete posts using the post insert pre drilled holes as a guide. Use 6mm concrete drill bit for drilling, use 6 concrete screws provided.

- Make sure concrete plinths are level.

- Using metal posts, make holes 60cm in ground, leaving 1850cm of post above ground.

- Use 3-3.5 bags of rapid cement to fill holes.

- Follow instructions on cement bags.

- When fixing posts use plinths as spacers to determine post position. Use the tex self-drilling screws in post to fix post insert to metal post.

2. - Put two plinths in place.
- Make sure plinths are level.



3. Fix post insert with pre drilled holes to the top.



4. Use 3 pre drilled holes on post inserts.

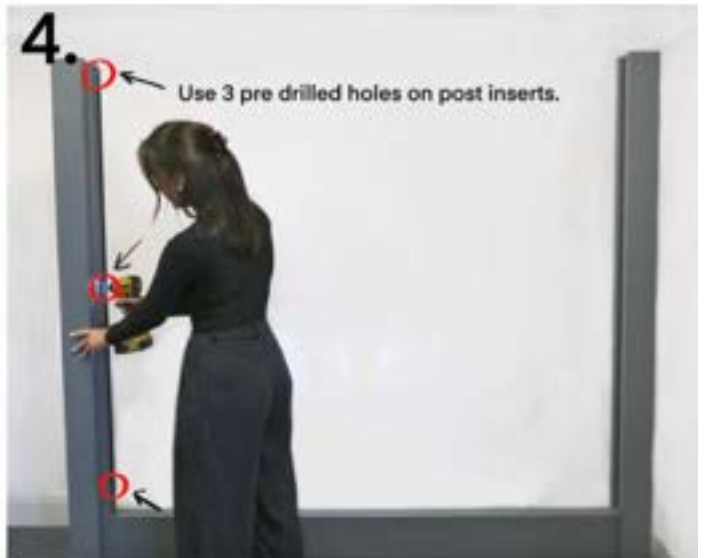

5.

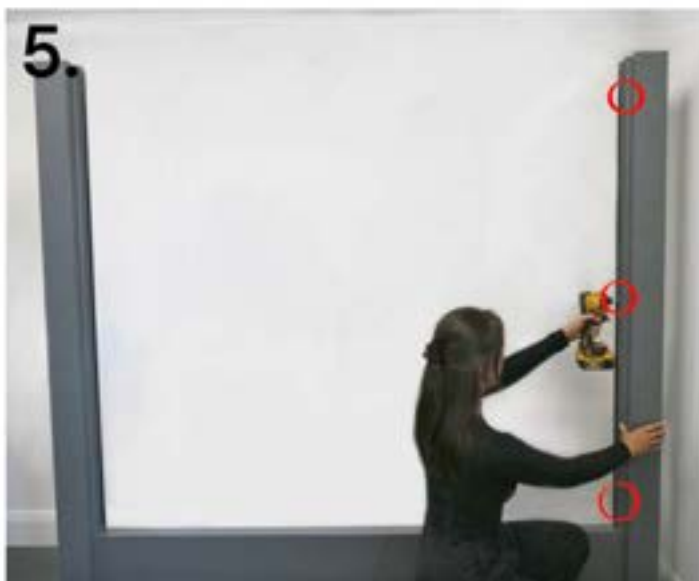

6. Slide in panels with bullet nose facing downward.







Satus FENCETM

Distributed in Ireland by
Irish International Trading Corporation
www.iitc.ie

Tramore Road, Cork, T12WK59
021 4705800 | info@iitc.ie

Hibernian Salt, Tivoli Industrial Estate,
Cork, T23 VH96
021 4559955 | info@iitc.ie

Osberstown Business Park, Osberstown,
Naas, Co Kildare, W91 EDN7
045 888300 | info@iitc.ie